

Project identification

## Combiplan Project, Nijverdal

Type of project

Structural design for the combined road and railway tunnel

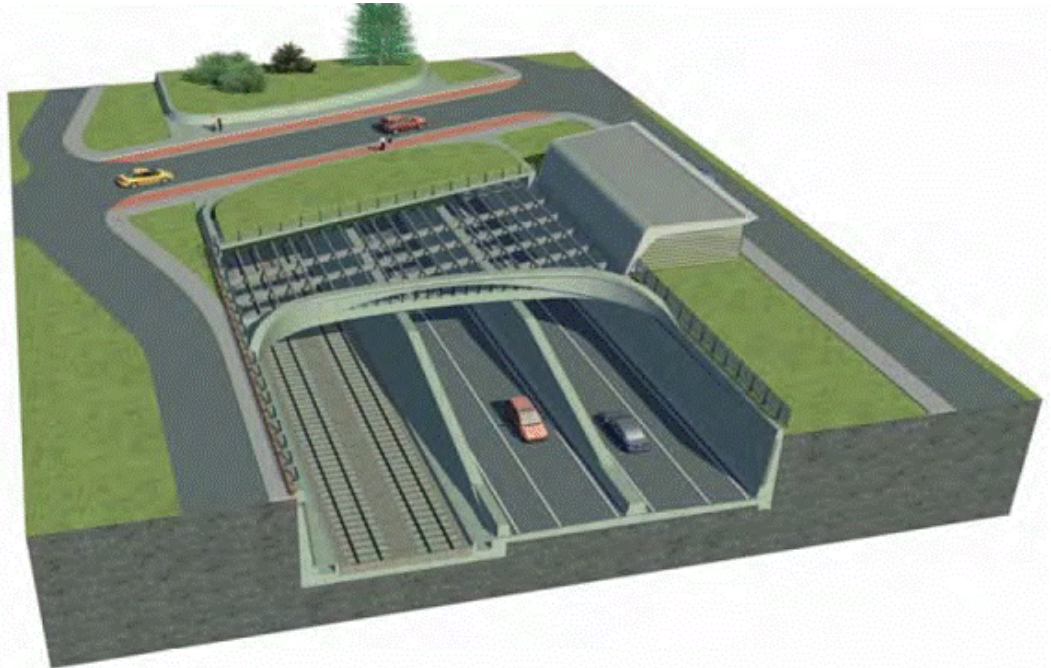

Client

Royal Haskoning

Project assignment

Structural design for the combined road en railway tunnel in Nijverdal

Country

The Netherlands

Location

Nijverdal

Project duration

2008 - 2012

Project phases

Design + execution

Construction cost

EUR 60.000.000  
(excl. VAT)

Consultancy fee

EUR 1.200.000  
(excl. VAT)

**Office**

Laan 1914 no 35  
3818 EX Amersfoort  
P.O.Box 28013  
3828 ZG Amersfoort  
The Netherlands

**Telephone**

+31 (0)88 348 2540

**E-mail**

info@TEC-tunnel.com

**URL**

www.TEC-tunnel.com

Project identification

## **Combiplan project, Nijverdal**

Type of project

Structural design for the combined road and railway tunnel

---

Project description

The centre of Nijverdal is one of the last city centres in the Netherlands that is split in two by a national highway. This obviously has a detrimental effect on the liveability, traffic flow and traffic safety in the Nijverdal centre. To improve this situation, the city council, together with the Netherlands Ministry of Transport and Public Works have initiated the “Combiplan” project that aims at abandoning the through traffic from crossing the city centre.

The Nijverdal Combiplan project includes a 400-m long tunnel section, with an open-tunnel section and approach ramps on both ends. The tunnel will accommodate 2 x 2 traffic lanes, each of which will be in a separate tube. The tunnel will also accommodate the double track railway line.

The complete project that also includes all associated works on the surface is realised under Design & Built. The contractor for the project invited Royal Haskoning to provide the structural design for the road and railway tunnel. Royal Haskoning has undertaken this assignment using System Engineering methodology.